



THE WESTIN
BOSTON
WATERFRONT

Floor Plans + Capacity Charts

Whether you're catching up with colleagues or convening for a convention, our planners are here to make your meeting or event effortless. With over 89,000 square feet of event space in 37 unique spaces, we offer countless ways to connect and collaborate in Boston's fastest growing neighborhood, the Seaport District.

Meeting Space

OVERVIEW PART 1

ROOMS AT A GLANCE

TOTAL GUESTROOMS	793
TOTAL MEETING ROOMS	37
LARGEST MEETING ROOM CAPACITY	1800
LARGEST MEETING ROOM SIZE	1,780 SQ M / 19,160 SQ FT

Additional spaces for meetings and events, not displayed here, may also be available. Contact your hotel representative for more information.

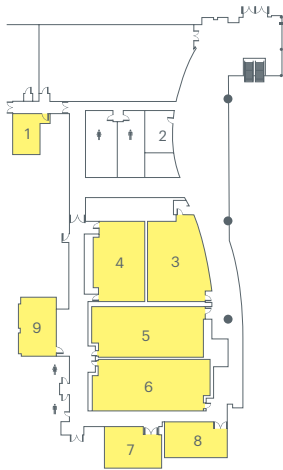

MEZZANINE LEVEL

- | | | |
|------------|-------------|------------------------|
| 1. Frost | 4. Adams | 7. Executive Boardroom |
| 2. Tangent | 5. Douglass | 8. Hale |
| 3. Alcott | 6. Faneuil | 9. Bulfinch |

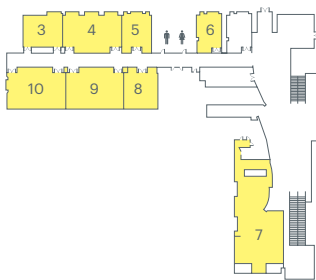

LOBBY LEVEL

- | | | |
|--------------------------|-------------|-------------|
| 1. Marina Ballroom | 5. Paine | 9. Stone |
| 2. Marina Ballroom Foyer | 6. Quincy | 10. Webster |
| 3. Hancock | 7. Sauciety | |
| 4. Otis | 8. Revere | |

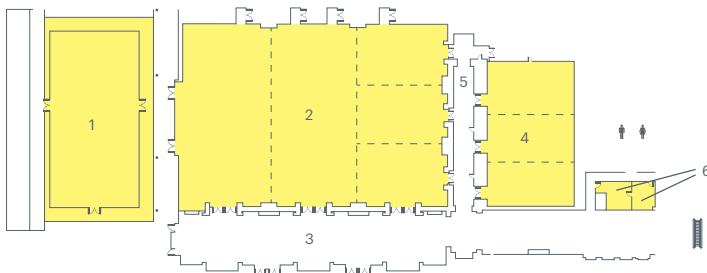

CONCOURSE LEVEL

- | | | |
|-------------------|--------------------------|--------------------------------|
| 1. Pavilion | 3. Grand Ballroom Foyer | 5. Commonwealth Ballroom Foyer |
| 2. Grand Ballroom | 4. Commonwealth Ballroom | |

THE WESTIN
BOSTON
WATERFRONT

425 Summer Street
Boston, MA 02210
USA

T +1 617.532.4600

westinbostonwaterfront.com

Meeting Space

OVERVIEW PART 2

ROOMS AT A GLANCE

TOTAL GUESTROOMS	793
TOTAL MEETING ROOMS	37
LARGEST MEETING ROOM CAPACITY	1800
LARGEST MEETING ROOM SIZE	1,780 SQ M / 19,160 SQ FT

Additional spaces for meetings and events, not displayed here, may also be available. Contact your hotel representative for more information.

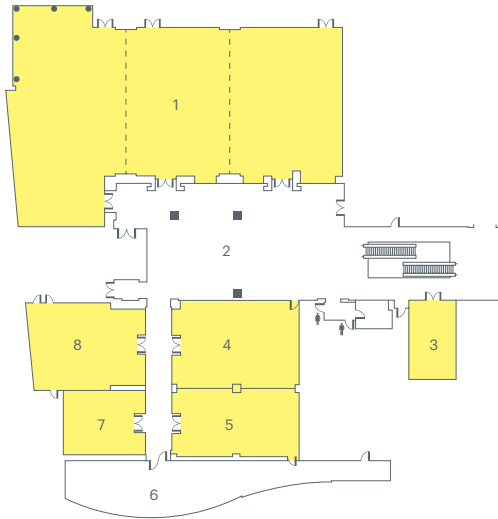

HARBOR LEVEL

- | | | |
|---------------------------|-------------------|------------|
| 1. Harbor Ballroom | 4. Burroughs | 7. Griffin |
| 2. Harbor Ballroom Foyer | 5. Carlton | 8. Lewis |
| 3. Independence Boardroom | 6. Harbor Terrace | |

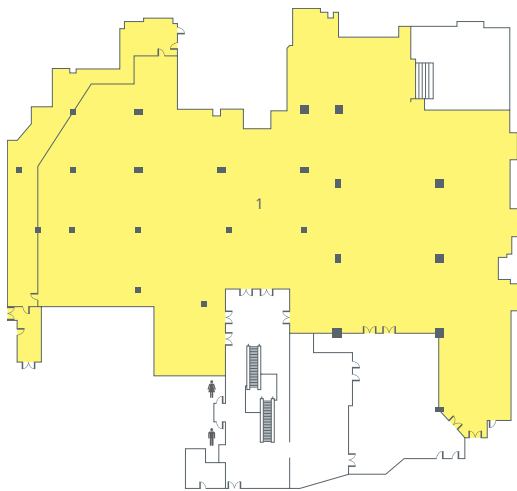

GALLERIA

1. Galleria

THE WESTIN
BOSTON
WATERFRONT

425 Summer Street
Boston, MA 02210
USA

T +1 617.532.4600

westinbostonwaterfront.com

Mezzanine Level

MEETING SPACE

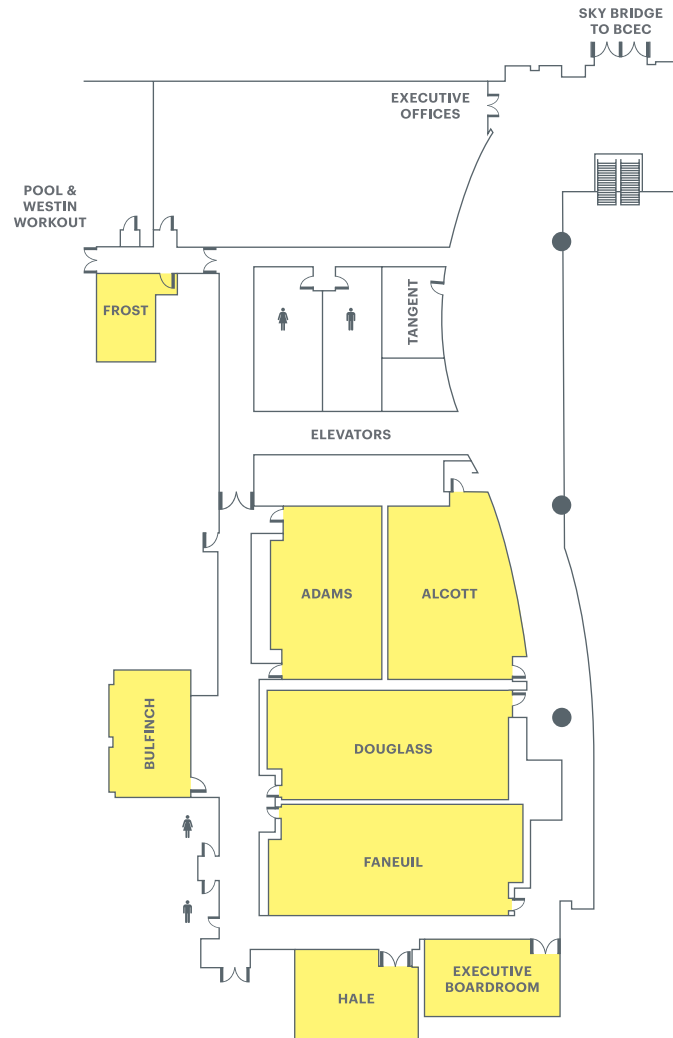

ROOM NAME	DIMENSIONS	AREA SQ FEET	MAX CEILING HEIGHT	THEATER	THEATER CHEVRON	CLASSROOM	CLASSROOM CHEVRON	BANQUET	CONFERENCE	U-SHAPE	HOLLOW SQ	RECEPTION
MEZZANINE LEVEL												
ADAMS	24' X 38'	833	11.5'	90	—	45	—	60	30	30	36	80
ALCOTT	29' X 41'	1,035	11.5'	100	—	63	—	70	30	30	36	105
BULFINCH	19' X 41'	508	11.5'	40	—	24	—	30	18	18	24	40
DOUGLASS	53' X 24'	1,254	11.5'	130	—	76	—	80	36	42	48	130
EXECUTIVE BOARDROOM	20' X 39'	722	12'	—	—	—	—	—	18	—	—	—
FANEUIL	56' X 24'	1,298	11.5'	130	—	76	—	80	36	42	48	130
FROST BOARDROOM	19' X 17'	265	8.5'	—	—	—	—	—	10	—	—	—
HALE	24' X 26'	564	11.5'	40	—	24	—	40	18	18	24	40

THE WESTIN
BOSTON
WATERFRONT

425 Summer Street
Boston, MA 02210
USA

T +1 617.532.4600

westinbostonwaterfront.com

Lobby Level

MEETING SPACE

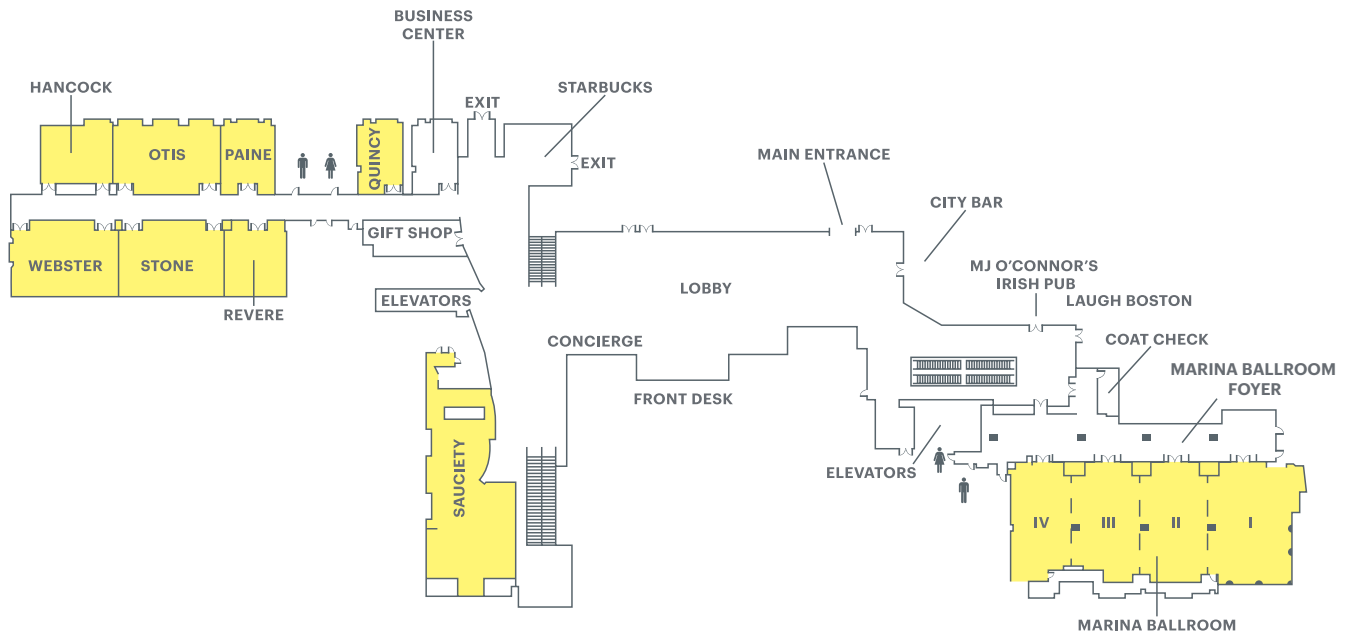

ROOM NAME	DIMENSIONS	AREA SQ FEET	MAX CEILING HEIGHT	THEATER	THEATER CHEVRON	CLASSROOM	CLASSROOM CHEVRON	BANQUET	CONFERENCE	U-SHAPE	HOLLOW SQ	RECEPTION
LOBBY LEVEL												
HANCOCK	29' X 32'	854	14'	80	—	45	—	60	24	24	30	80
MARINA BALLROOM + FOYER	102' X 155'	9,749	13.5'	—	—	—	—	—	—	—	—	750
MARINA BALLROOM	54' X 131'	6,170	13.5'	588	412	378	340	420	—	—	—	650
MARINA I	54' X 44'	2,031	13.5'	192	134	128	115	120	38	48	54	235
MARINA I-II	54' X 74'	3,483	13.5'	324	227	213	192	230	60	54	60	400
MARINA I-III	54' X 104'	4,888	13.5'	456	319	306	275	348	84	81	90	560
MARINA II	51' X 30'	1,452	13.5'	132	92	93	84	110	32	39	48	170
MARINA II-III	52' X 60'	2,859	13.5'	264	185	186	167	220	48	48	54	315
MARINA II-IV	52' X 87'	4,143	13.5'	396	277	258	232	300	72	72	78	450
MARINA III	52' X 30'	1,407	13.5'	132	92	93	84	110	32	39	48	168
MARINA III-IV	52' X 57'	2,564	13.5'	264	185	150	135	190	44	39	48	282
MARINA IV	52' X 27'	1,284	13.5'	132	92	72	65	80	32	39	48	130
OTIS	32' X 46'	1,377	14'	140	—	72	—	100	38	39	48	150
PAINE	32' X 24'	737	14'	80	—	36	—	50	18	24	30	70
QUINCY	32' X 20'	601	14'	60	—	24	—	40	18	21	24	50
REVERE	32' X 25'	757	14'	80	—	36	—	50	18	24	30	70
SAUCIETY	40' X 107'	2,898	13'	—	—	—	—	—	—	—	—	300
STONE	32' X 46'	1,416	12.5'	140	—	72	—	100	38	39	48	155
WEBSTER	32' X 47'	1,424	14'	140	—	72	—	110	38	39	48	155

THE WESTIN
BOSTON
WATERFRONT

425 Summer Street
Boston, MA 02210
USA

T +1 617.532.4600

westinbostonwaterfront.com

This document contains approximate measurements that are for illustrative purposes only. We cannot guarantee the floor plan accuracy or completeness and therefore encourage you to review the space to make sure it is suitable for your event.

Concourse Level

MEETING SPACE

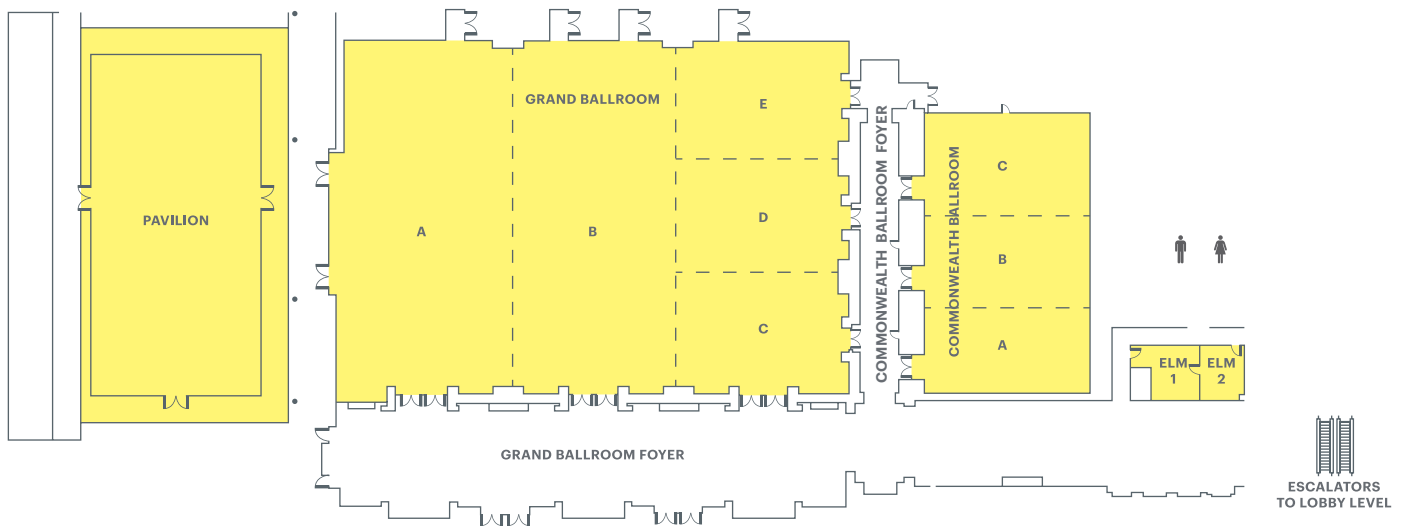

ROOM NAME	DIMENSIONS	AREA SQ FEET	MAX CEILING HEIGHT	THEATER	CHEVRON	CLASSROOM	CLASSROOM CHEVRON	BANQUET	CONFERENCE	U-SHAPE	HOLLOW SQ	RECEPTION
CONCOURSE LEVEL												
COMMONWEALTH BALLROOM	52' X 82'	3,956	14'	340	238	240	216	280	—	75	90	420
COMMONWEALTH A	52' X 25'	1,212	14'	120	84	63	57	80	32	36	42	128
COMMONWEALTH A-B	52' X 51'	2,478	14'	250	175	120	108	200	—	50	60	260
COMMONWEALTH B	52' X 26'	1,267	14"	120	84	63	57	80	32	36	42	128
COMMONWEALTH B-C	52' X 57'	2,744	14'	280	196	120	108	200	—	44	72	200
COMMONWEALTH C	52' X 21'	1,477	14'	150	105	84	76	110	32	42	48	110
ELM I-II	15' X 12'	425	9'	—	—	—	—	—	—	—	—	—
ELM I	15' X 12'	182	9'	—	—	—	—	—	8	—	—	—
ELM II	15' X 19'	242	9'	—	—	—	—	—	6	—	—	—
GRAND BALLROOM	112' X 151'	15,077	24'	1,500	1050	860	774	1,080	—	—	—	1,500
GRAND FOYER	—	6,444	14'	—	—	—	—	—	—	—	—	695
GRAND A	112' X 52'	5,047	24'	552	386	270	243	320	—	—	—	540
GRAND A-B	112' X 101'	10,110	24'	1,100	770	570	513	720	—	—	—	1,000
GRAND B	112' X 49'	5,064	24'	552	386	270	243	320	—	—	—	540
GRAND B-E	112' X 109'	10,030	24'	1,100	770	570	513	720	—	—	—	1,000
GRAND C	35' X 50'	1,636	24'	150	105	84	76	120	36	45	54	165
GRAND C-D	69' X 50'	3,266	24'	340	238	168	151	240	—	—	—	330
GRAND C-E	112' X 50'	4,967	24'	460	322	270	243	320	—	—	—	522
GRAND D	34' X 50'	1,630	24'	150	105	84	76	120	36	45	54	165
GRAND D-E	77' X 50'	3,331	24'	360	252	168	151	240	—	—	—	330
GRAND E	43' X 50'	1,701	24'	180	126	84	76	120	36	45	54	165
PAVILION	49' X 99'	4,846	24'	500	350	342	308	320	—	—	—	600

THE WESTIN
BOSTON
WATERFRONT

425 Summer Street
Boston, MA 02210
USA

T +1 617.532.4600

westinbostonwaterfront.com

Harbor Level

MEETING SPACE

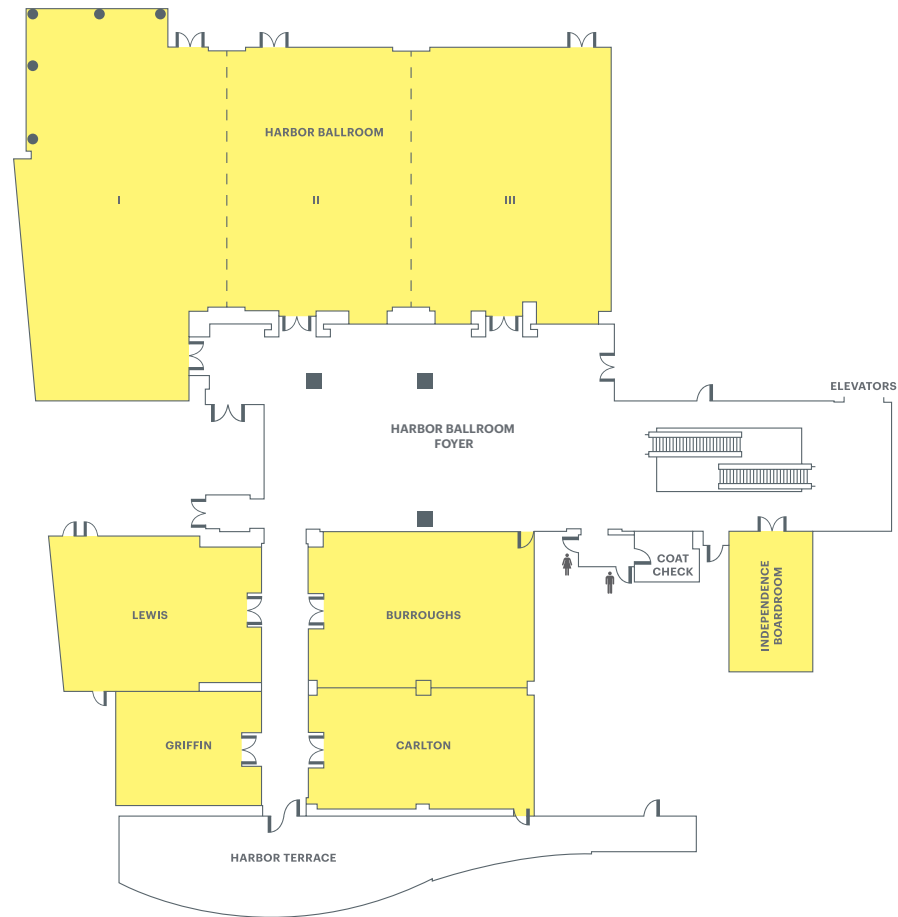

ROOM NAME	DIMENSIONS	AREA SQ FEET	MAX CEILING HEIGHT	THEATER	CHEVRON	CLASSROOM	CHEVRON	BANQUET	CONFERENCE	U-SHAPE	HOLLOW SQ	RECEPTION
HARBOR LEVEL												
BURROUGHS	32' X 48'	1,492	11.5'	160	—	84	—	120	34	39	48	160
CARLTON	48' X 26'	1,181	11.5'	120	—	60	—	80	34	36	42	130
GRIFFIN	30' X 24'	679	11.5'	70	—	33	—	40	18	18	24	60
HARBOR BALLROOM	84' X 128'	7,987	19'	860	602	390	351	680	—	—	—	850
HARBOR FOYER	—	5,487	11.5'	—	—	—	—	—	—	—	—	500
HARBOR I	84' X 46'	3,318	19'	360	252	160	144	290	—	66	78	360
HARBOR I-II	84' X 85'	5,543	19'	580	406	290	261	490	—	—	—	615
HARBOR II	58' X 39'	2,226	19'	240	168	130	117	200	—	48	60	240
HARBOR II-III	58' X 82'	4,666	19'	500	350	280	252	400	—	—	—	510
HARBOR III	58' X 43'	2,444	19'	260	182	160	144	200	—	50	66	270
HARBOR TERRACE	22' X 123'	1,802	—	—	—	—	—	—	—	—	—	—
INDEPENDENCE	29' X 18'	522	11.5'	—	—	—	—	—	16	—	—	—
LEWIS	45' X 33'	1,349	11.5'	140	98	72	65	90	28	33	42	130

THE WESTIN
BOSTON
WATERFRONT

425 Summer Street
Boston, MA 02210
USA

T +1 617.532.4600

westinbostonwaterfront.com

Galleria

MEETING SPACE

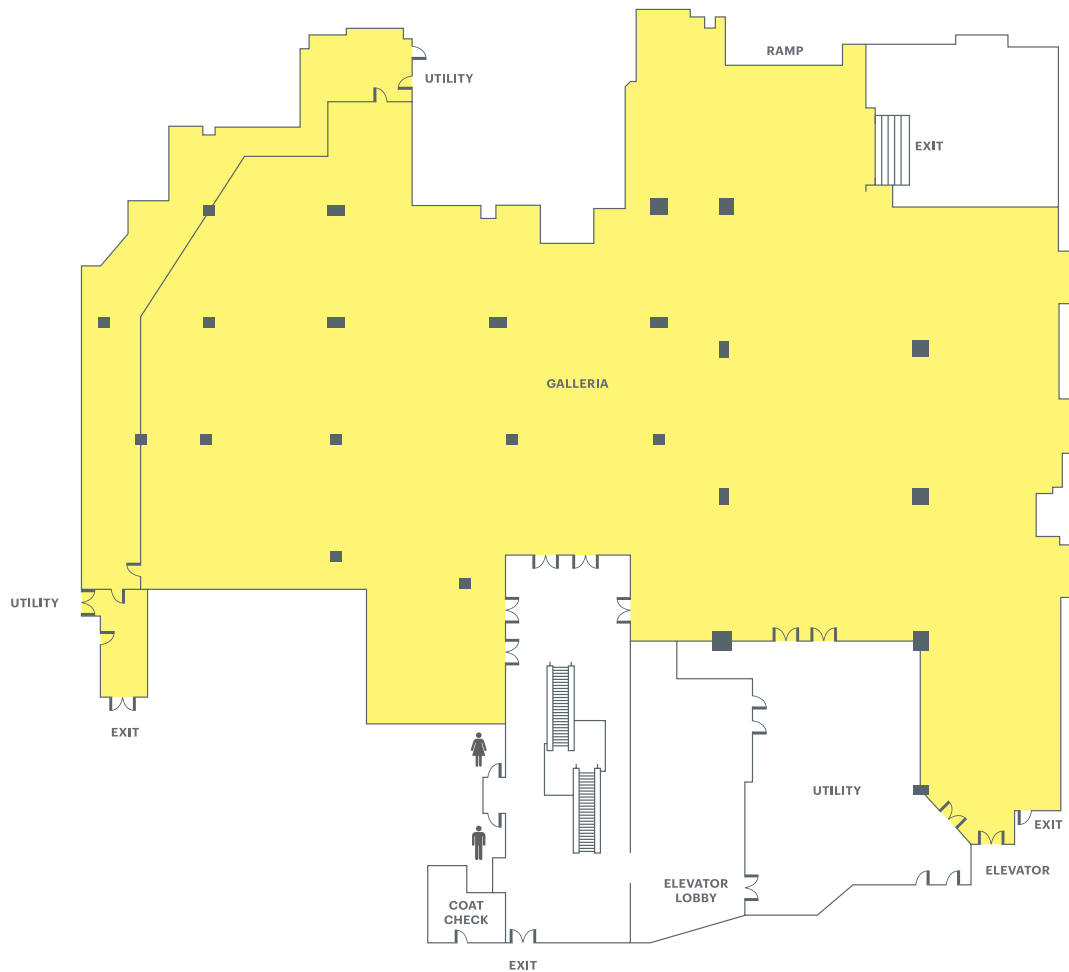

ROOM NAME	DIMENSIONS	AREA SQ FEET	MAX CEILING HEIGHT	THEATER	THEATER CHEVRON	CLASSROOM	CLASSROOM CHEVRON	BANQUET	CONFERENCE	U-SHAPE	HOLLOW SQ	RECEPTION
GALLERIA LEVEL												
GALLERIA	187' X 121'	19,160	14.5'	-	-	-	-	1,050	-	-	-	2,000

THE WESTIN
BOSTON
WATERFRONT

425 Summer Street
Boston, MA 02210
USA

T +1 617.532.4600

westinbostonwaterfront.com



THE WESTIN
BOSTON
WATERFRONT

425 Summer Street
Boston, MA 02210
USA

T +1 617.532.4600

westinbostonwaterfront.com



©2017 Starwood Hotels & Resorts Worldwide, Inc. All Rights Reserved. Preferred Guest, SPG, Westin and their logos are the trademarks of Starwood Hotels & Resorts Worldwide, Inc., or its affiliates. For full terms and conditions, visit westinbostonwaterfront.com.